

LIMA HIGH GLOSS TV UNIT ASSEMBLY INSTRUCTIONS

Thank you for purchasing the Lima High Gloss TV Unit.
Please read the instructions carefully to ensure safe operation of this product.

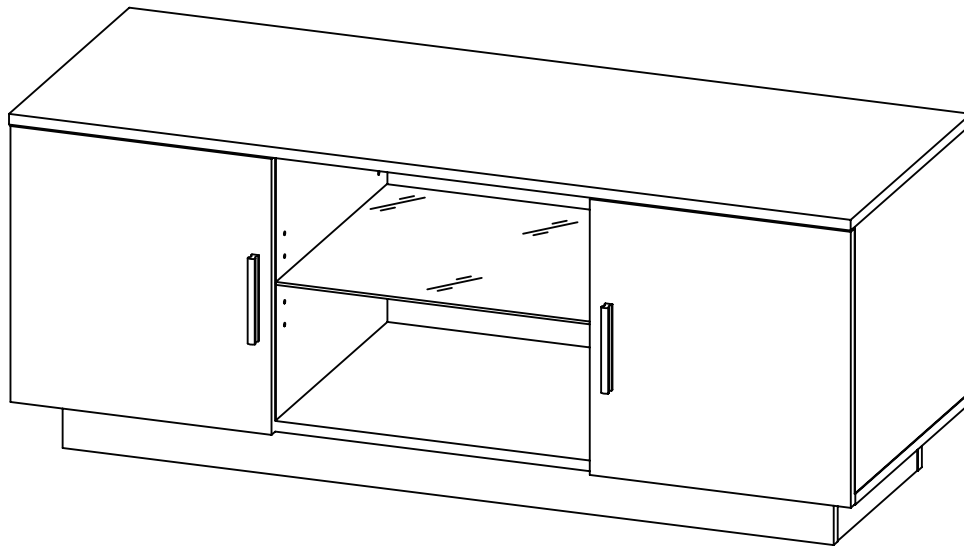

Size: 119 x 45 x 48.5 cm (WDH)

Colour: Black, Grey or White

Finish: Melamine Veneer & Gloss Doors

PLEASE READ this sheet prior to assembly to familiarise yourself with the various stages of construction.

Carefully open the pack supplied and check the contents against the parts and fittings check list. Do not destroy any of the packaging until you are certain that you have all the necessary parts for the assembly.

CAUTION: There are small components used in the construction of this unit. These loose items should be kept away from young children whilst assembling your unit to avoid the danger of choking.

Tools Required

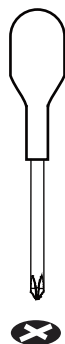
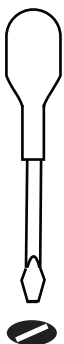

Number of people



1 Hour
Set Up

LIMA HIGH GLOSS TV UNIT ASSEMBLY INSTRUCTIONS

IMPORTANT - READ CAREFULLY - RETAIN THESE INSTRUCTIONS FOR FUTURE REFERENCE.

INFORMATION

- This product is designed to hold 25Kg in total spread evenly over the unit.
- Do not exceed this weight.
- We recommend that this unit is assembled in the room intended for use.
- When you are ready to start, make sure that you have the right tools, plenty of space and a clean, dry area for assembly.
- Unwrap all packaging materials and place the components on top of the carton box or on a clean floor to prevent it from scratching.
- Check the pack and make sure you have all the parts listed.
- Ensure that this product is fully assembled as illustrated before use.
- Check all screws or bolts are tightened and inspect regularly
- Tools not included unless specified in parts list.

WARNINGS

- This product should only be used on a firm and level floor.
- Keep small parts out of reach of children.
- Make sure the base remains in contact with the floor.
- DO NOT use power tools to construct this product.
- DO NOT tighten screws until parts are assembled or as advised in this guide.
- DO NOT over tighten screws or bolts.
- DO NOT use this product if parts are missing, damaged or worn.
- DO NOT sit or stand on the product.

CARE INFORMATION

- Never use scourers, abrasives or chemical cleaners.
- To clean, wipe with a damp sponge and warm soapy water.
- Do not use solvent based cleaners or detergents as they can bleach or damage the product.

Parts and Fittings Checklist

Please check the pack contents before assembling the product. If any components are missing, please contact your retailer.

The fittings pack contains small items that should be kept away from children.

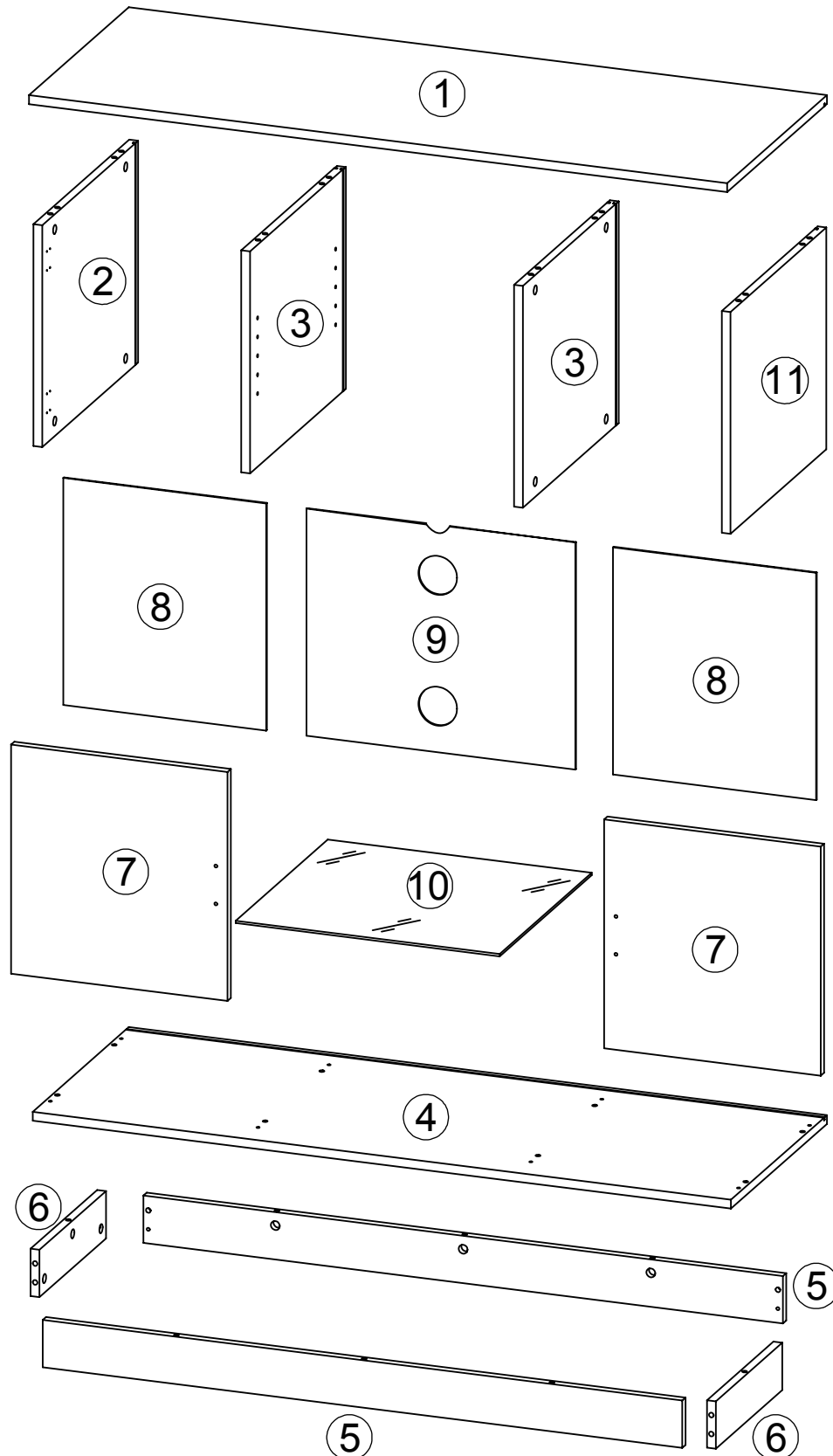

LIMA HIGH GLOSS TV UNIT ASSEMBLY INSTRUCTIONS

All parts are packed in one carton

1	2	3
Description: Top Panel Qty: 1 Size: 1190 x 450 x 15 mm Carton No: 1/1	Description: LH Side Panel Qty: 1 Size: 432 x 375 x 15 mm Carton No: 1/1	Description: Inner Dividers Qty: 2 Size: 432 x 375 x 15 mm Carton No: 1/1
4	5	6
Description: Base Panel Qty: 1 Size: 1190 x 433 x 15 mm Carton No: 1/1	Description: Plinths Qty: 2 Size: 1090 x 80 x 15 mm Carton No: 1/1	Description: Cross Plinths Qty: 2 Size: 300 x 80 x 15 mm Carton No: 1/1
7	8	9
Description: Doors Qty: 2 Size: 387 x 369 x 15 mm Carton No: 1/1	Description: Side Back Panels Qty: 2 Size: 347 x 383 x 3 mm Carton No: 1/1	Description: Centre Back Panel Qty: 1 Size: 458 x 383 x 3 mm Carton No: 1/1
10	11	
Description: Glass Shelf Qty: 1 Size: 450 x 415 x 4 mm Carton No: 1/1	Description: RH Side Panel Qty: 1 Size: 432 x 375 x 15 mm Carton No: 1/1	

General Hints & Tips

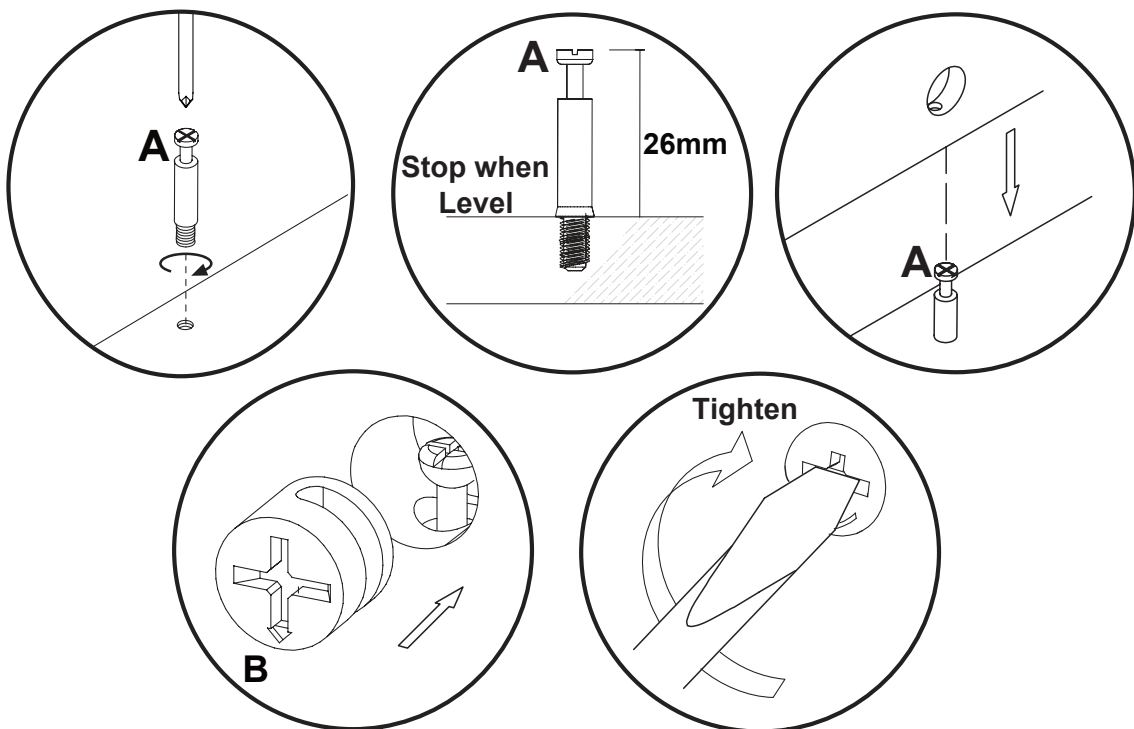

LIMA HIGH GLOSS TV UNIT ASSEMBLY INSTRUCTIONS

Fittings (to scale)

Code	Item	Quantity
A	Cam Bolt (35mm overall)	28
B	Cam Lock	28
C	Dowel (8x30mm)	20
D	Screw for Fitting Hinge and Anti-tilt Strap (3x12mm)	25
E	Bolt for Fitting Handle (M4x18mm)	4

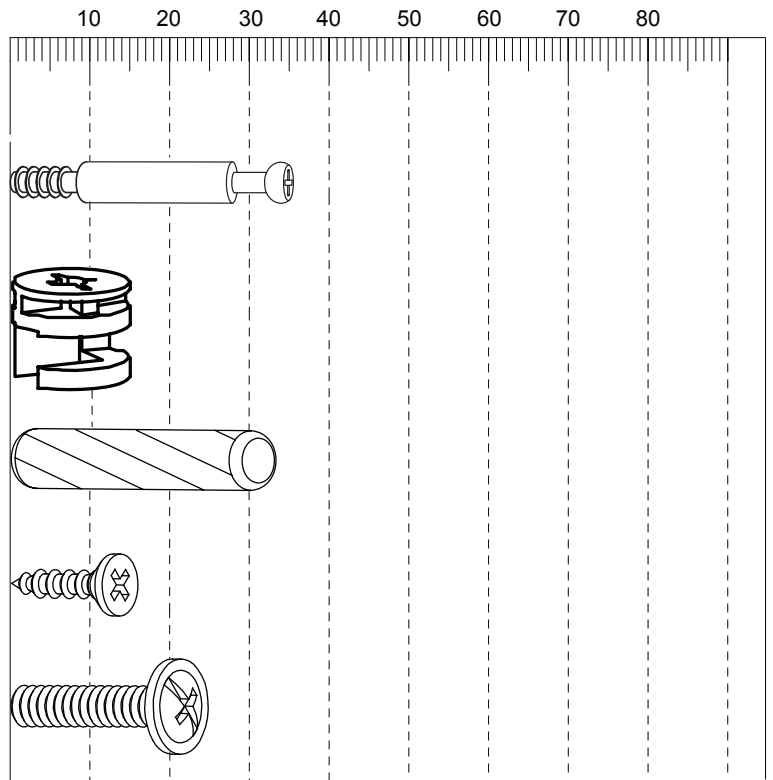

Fittings (not to scale)

Code	Item	Quantity
F	Hinge	4
G	Shelf Support	4
H	Handle	2
J	Anti-tilt Strap	1

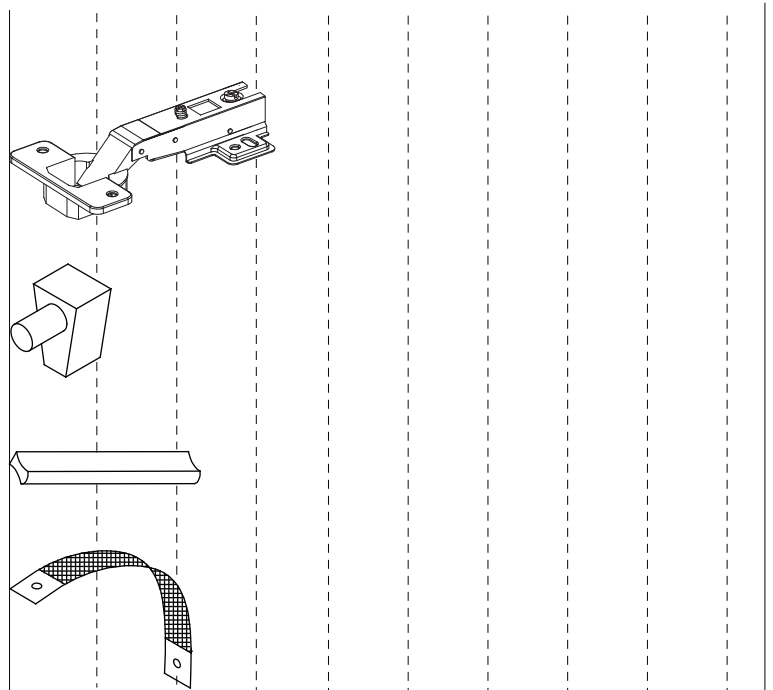

LIMA HIGH GLOSS TV UNIT ASSEMBLY INSTRUCTIONS

STEP 1

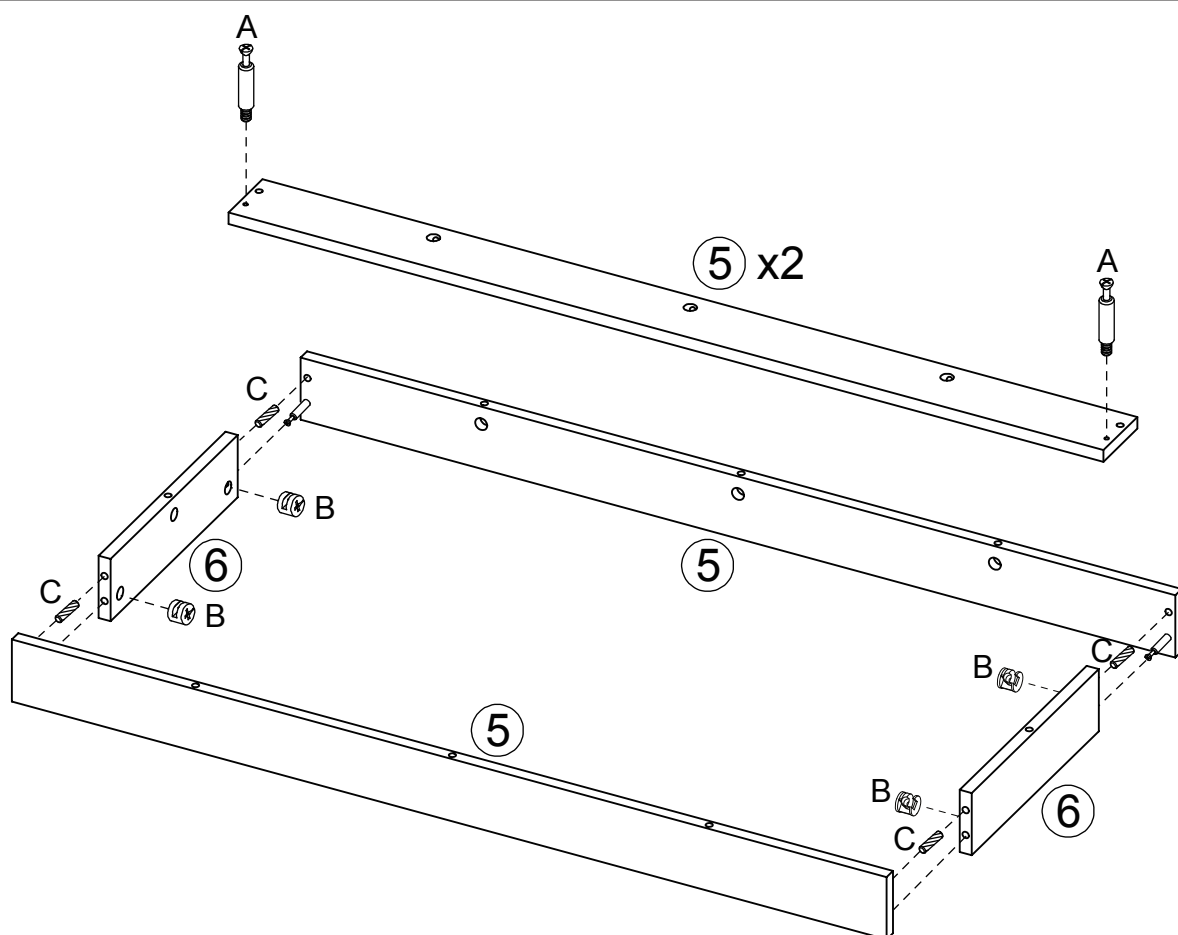

For this step:

Tools required

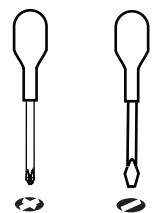

Fittings required

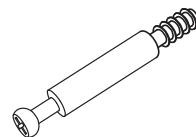

A x4



B x4

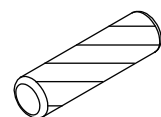

C x4

STEP 2

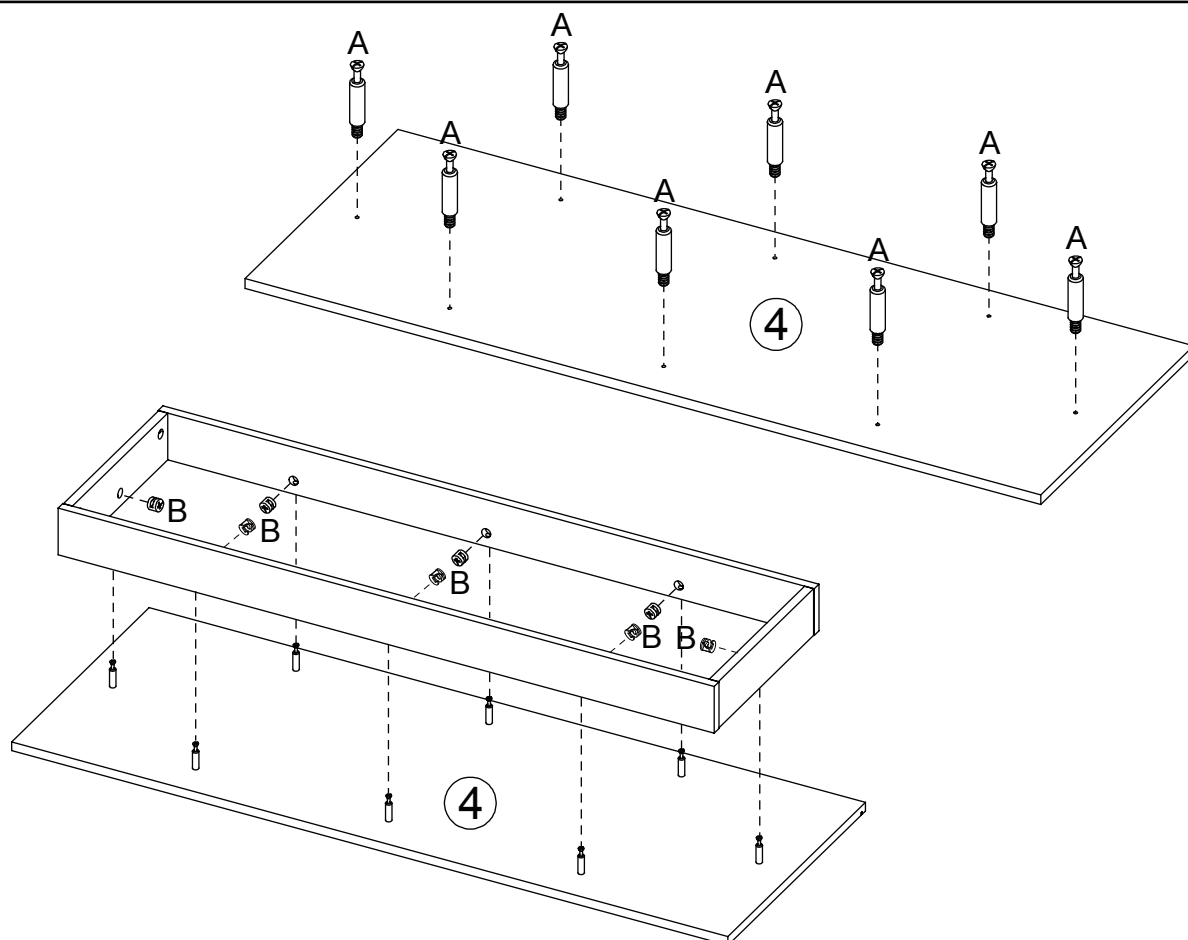

For this step:

Tools required

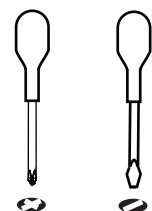

Fittings required

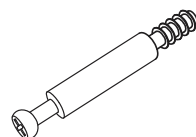

A x8



B x8

LIMA HIGH GLOSS TV UNIT ASSEMBLY INSTRUCTIONS

STEP 3

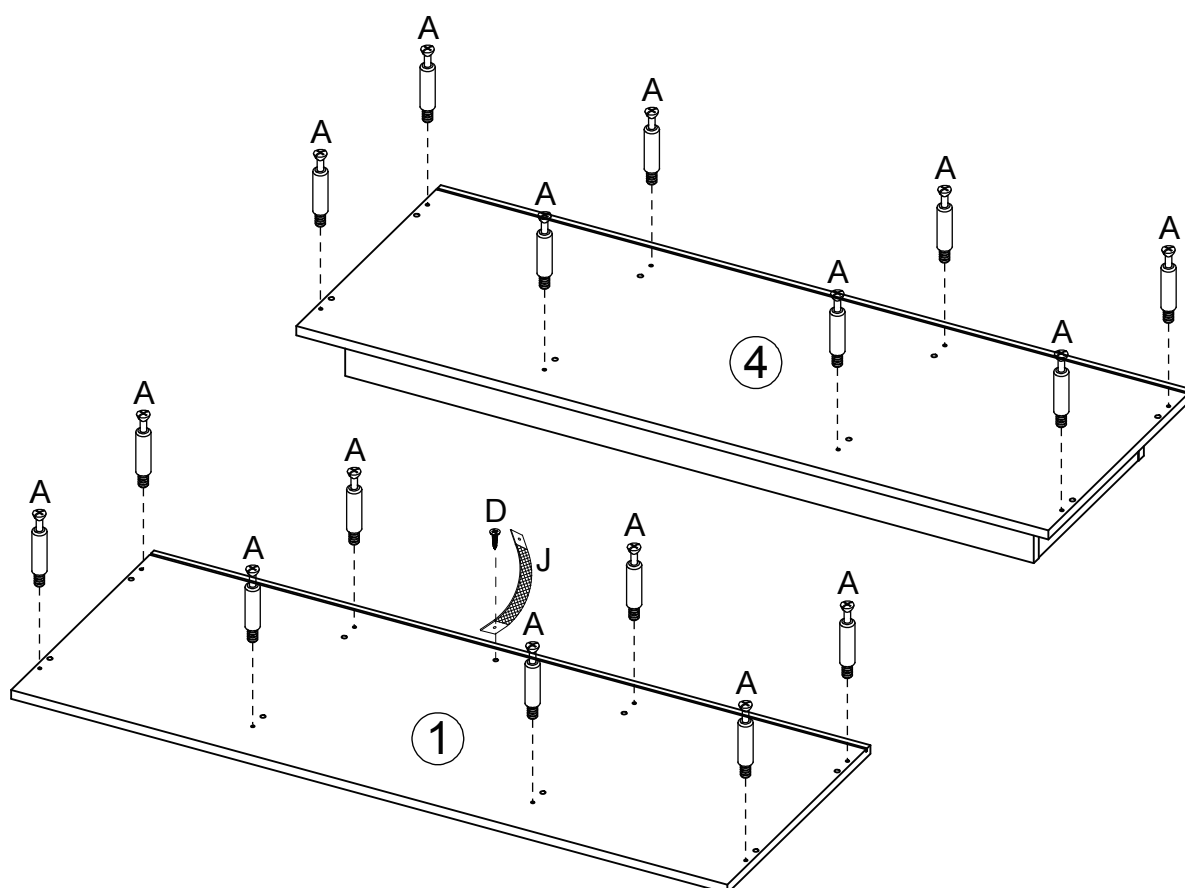

For this step:

Tools required



Fittings required

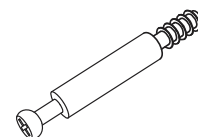

A x16

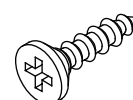

D x1

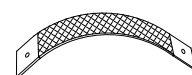

J x1

STEP 4

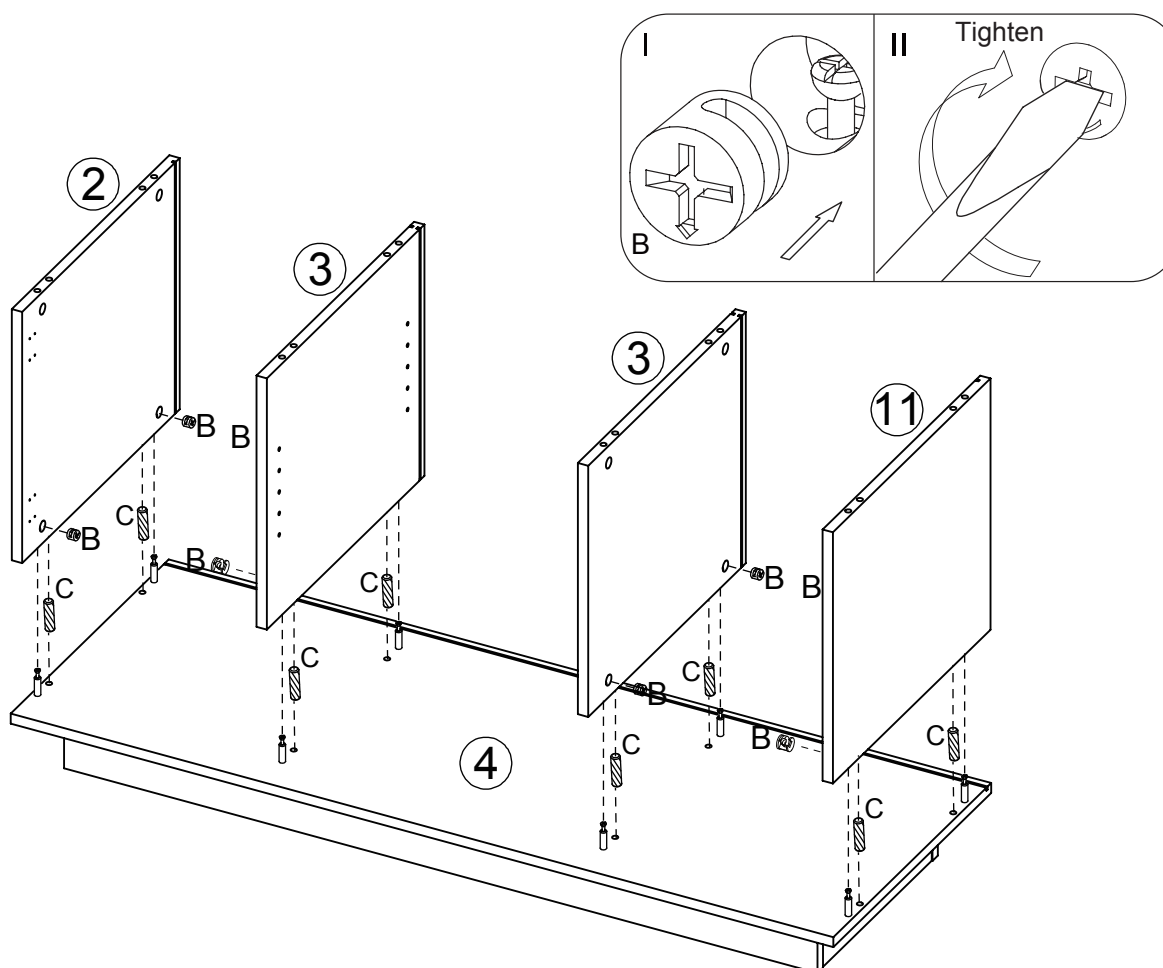

For this step:

Tools required



Fittings required



B x8

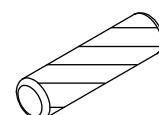

C x8

LIMA HIGH GLOSS TV UNIT ASSEMBLY INSTRUCTIONS

STEP 5

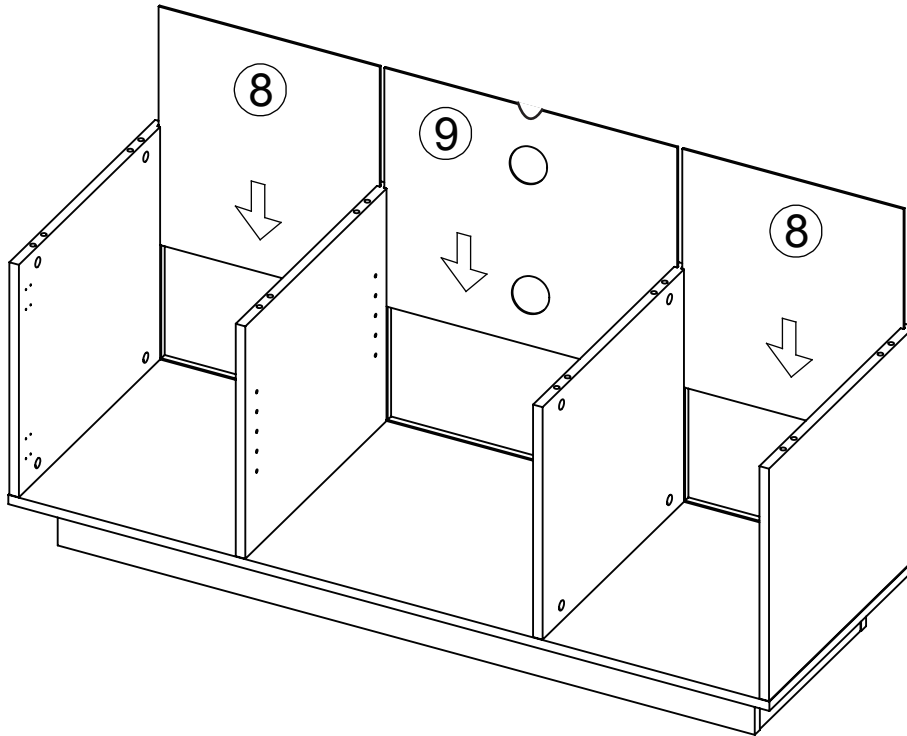

For this step:
Tools required

Fittings required

STEP 6

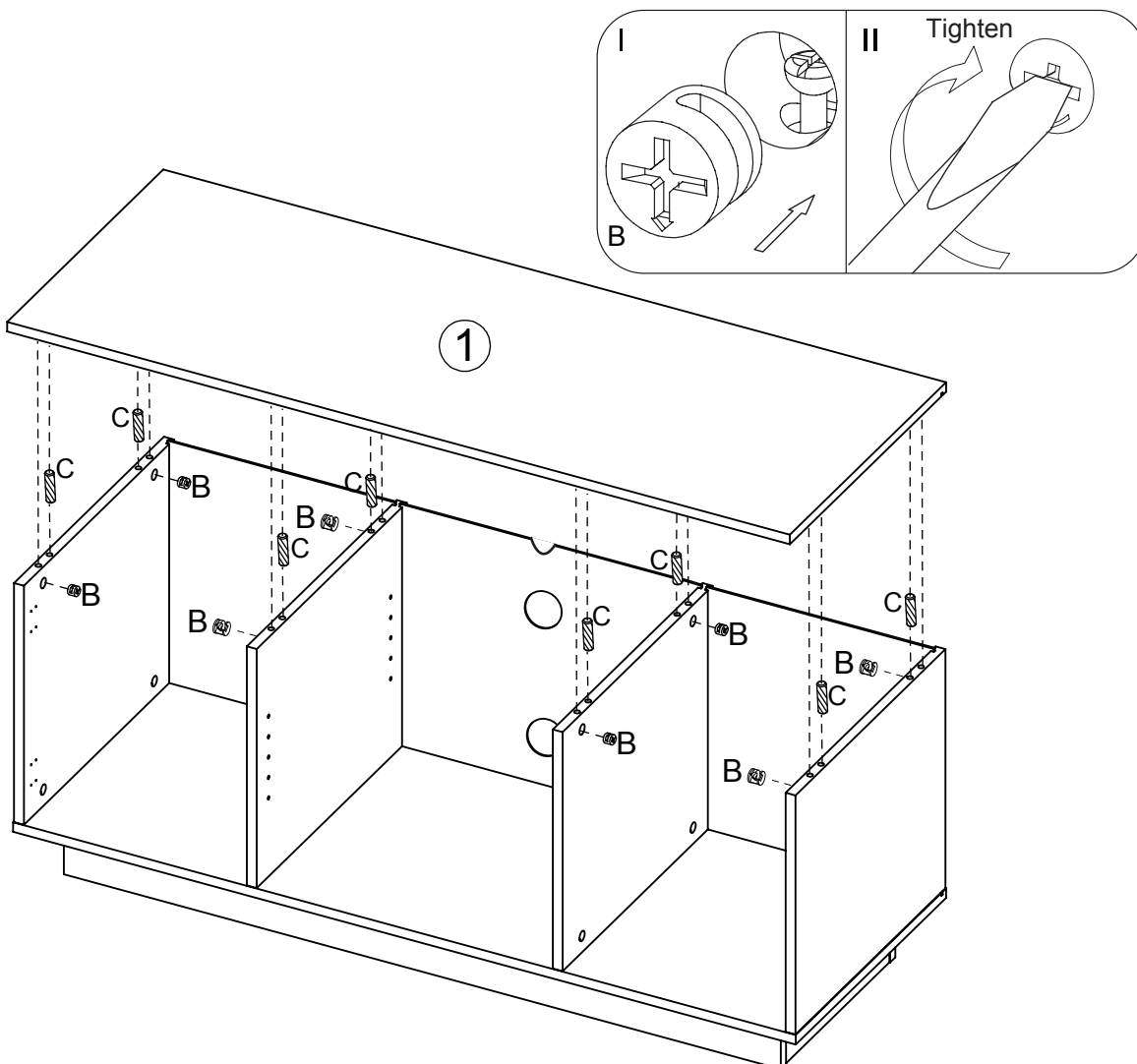

For this step:
Tools required

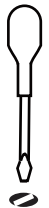

Fittings required



B x8

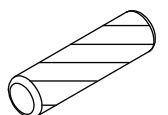

C x8

LIMA HIGH GLOSS TV UNIT ASSEMBLY INSTRUCTIONS

STEP 7

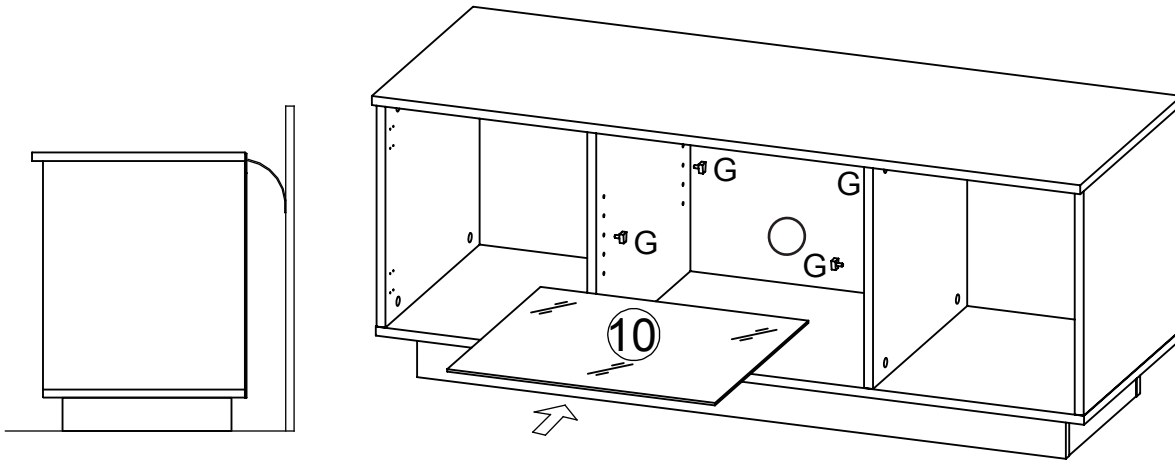

Note: We recommend the use of the wall strap provided (J) to avoid accidents and possible fatal injuries if the item falls over or tips over during use.

Warning: Always ensure the wall area to be drilled is free of electrical wires, water and gas pipes. We don't supply wall fixings as these must suit the wall type of your own home. If in doubt please consult a qualified trades person.

For this step:
Tools required

Fittings required

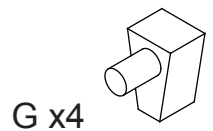

G x4

STEP 8

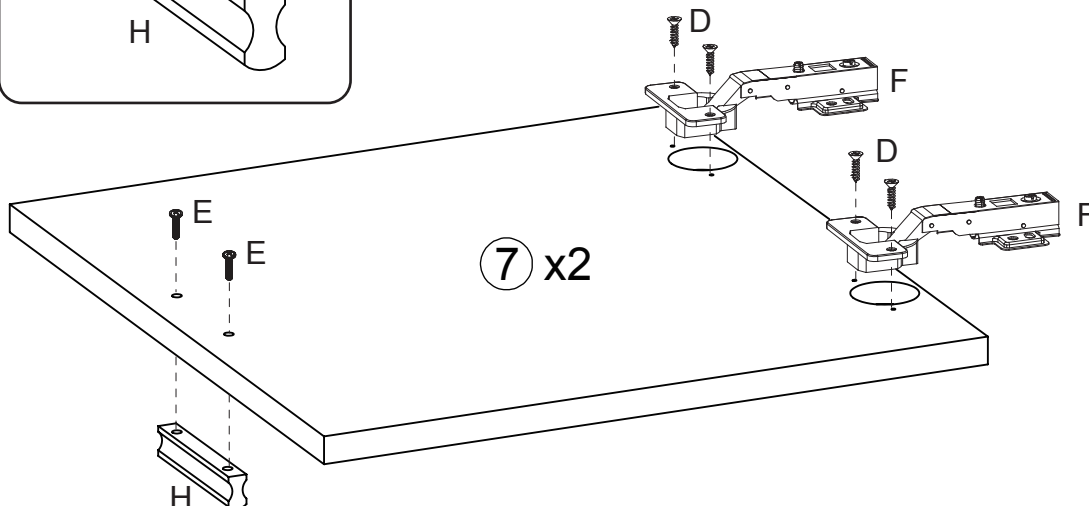
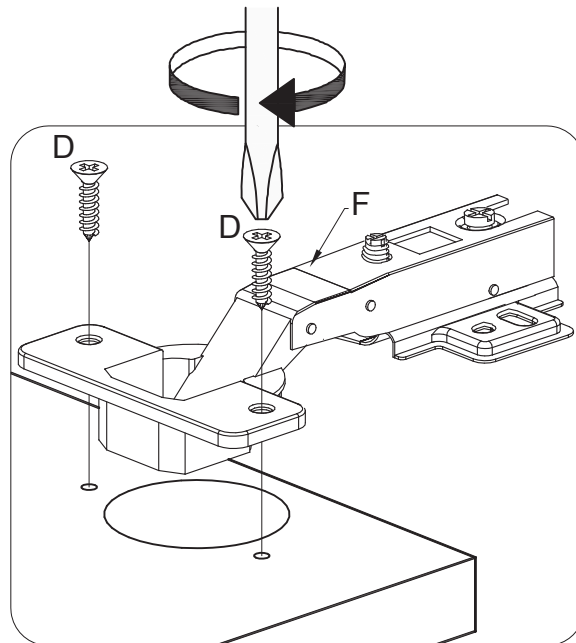
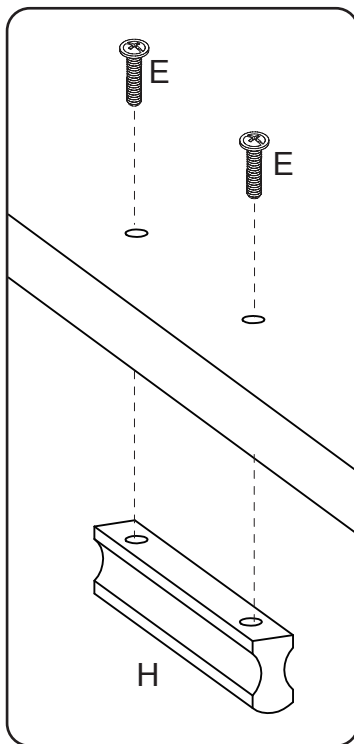

For this step:
Tools required

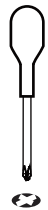

Fittings required

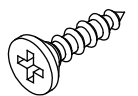

D x8

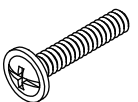

E x4

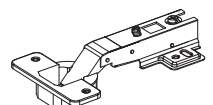

F x4

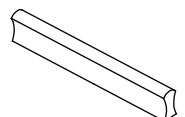

H x2

STEP 9

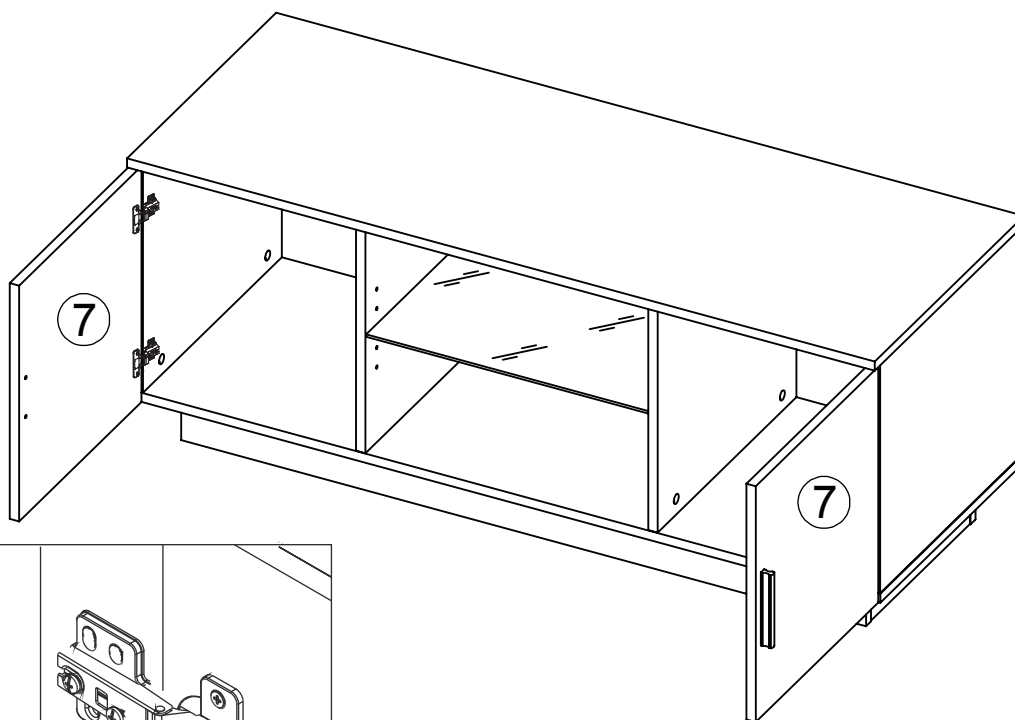

For this step:

Tools required



Fittings required

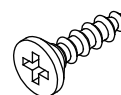

D x8

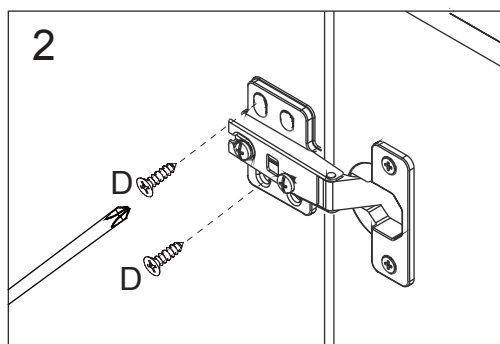
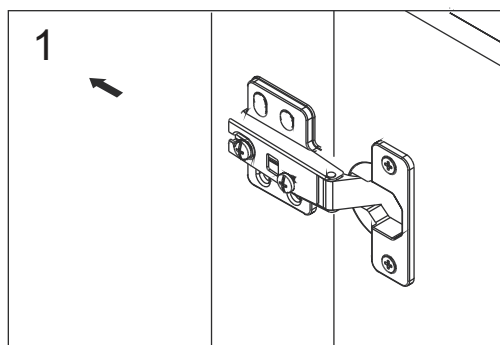

Adjusting door back or front

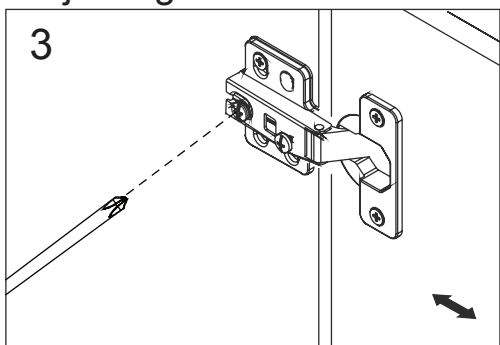

Adjusting door up or down

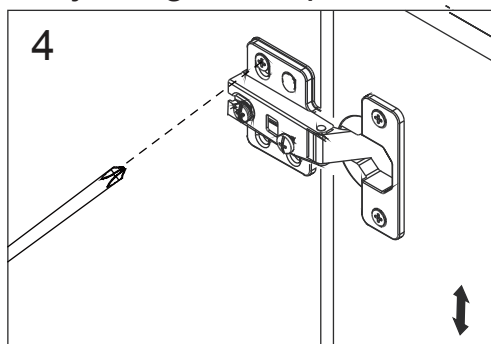

Adjusting door left or right

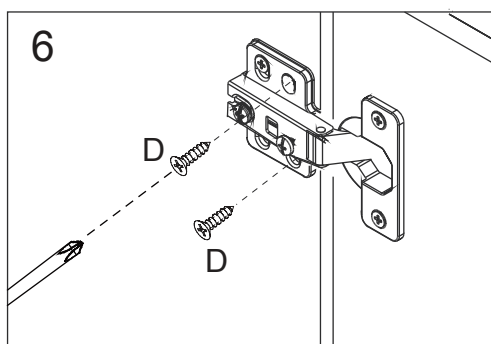
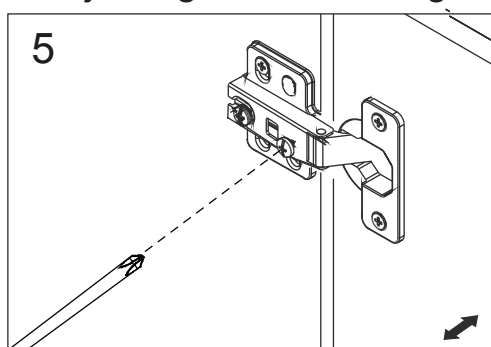

Fittings required

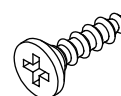

D x8

Once doors have been adjusted vertically, use screws (D) to fix plates (F) in their final position.

Assembly Completed

Your Lima High Gloss TV Unit is now completely assembled.

Periodically check to ensure that the components are in their proper position, free from damage.

Also, make sure the connectors are tight and secure.

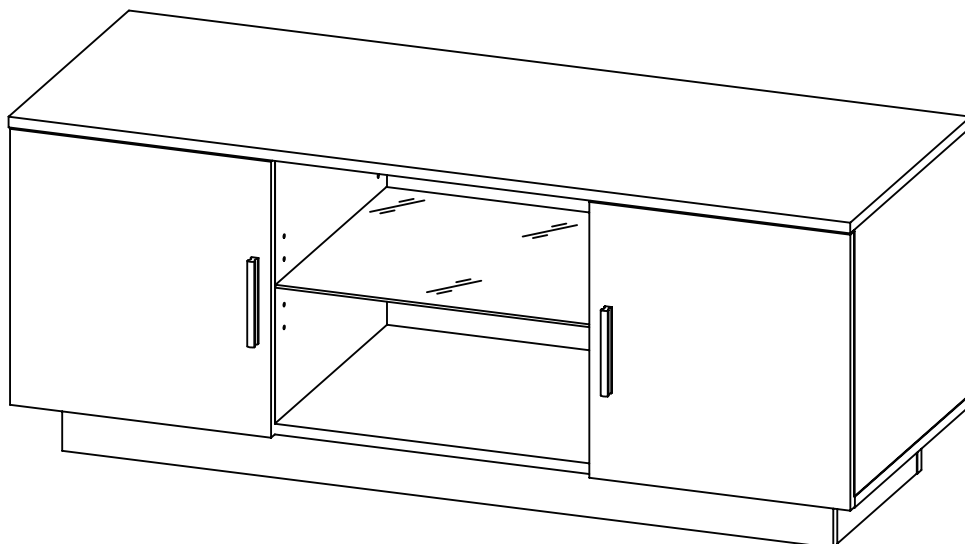

Keep instructions for future reference

