

ASSEMBLY INSTRUCTIONS

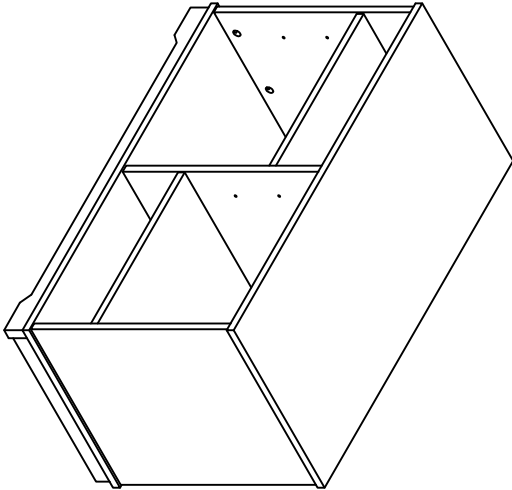

ASSEMBLY TIPS

- 1. Remove hardware from box and sort by size.
- 2. Please check to see that all hardware and parts are present prior start of assembly.
- 3. Please follow attached instructions in the same sequence as numbered to assure fast and easy assembly.



WARNING!

- 1. Don't attempt to repair or modify part that are broken or defective. Please contact the store immediately.
- 2. This product is for home use only and not intended for commercial establishments.

HARDWARE LIST		
1	22 pcs	8 pcs
MINIFIX CAM		BUCKLE FOR BACK PANEL
22 pcs		1 pc
2	7	
MINIFIX BOLT		H-PROFILE
14 pcs		
3		
WOOD SCREW 4.0 x 38mm		
18 pcs		
4		
WOOD DOWEL Ø8 x 30mm		
8 pcs		
5		
PVC SPRING SHELF SUPPORT		

COMPONENT LIST			
A	1 pc	H	1 pc
FRONT LOWER FRAME		BOTTOM PANEL	
B	1 pc	I	2 pcs
REAR LOWER RAIL		BACK PANEL	
C	1 pc	J	2 pcs
RIGHT LOWER PANEL		SHELF CABINET	
D	1 pc		
LEFT LOWER PANEL			
E	2 pcs		
SIDE PANEL			
F	1 pc		
CENTER PANEL			
G	1 pc		
TOP PANEL			

STEP 1

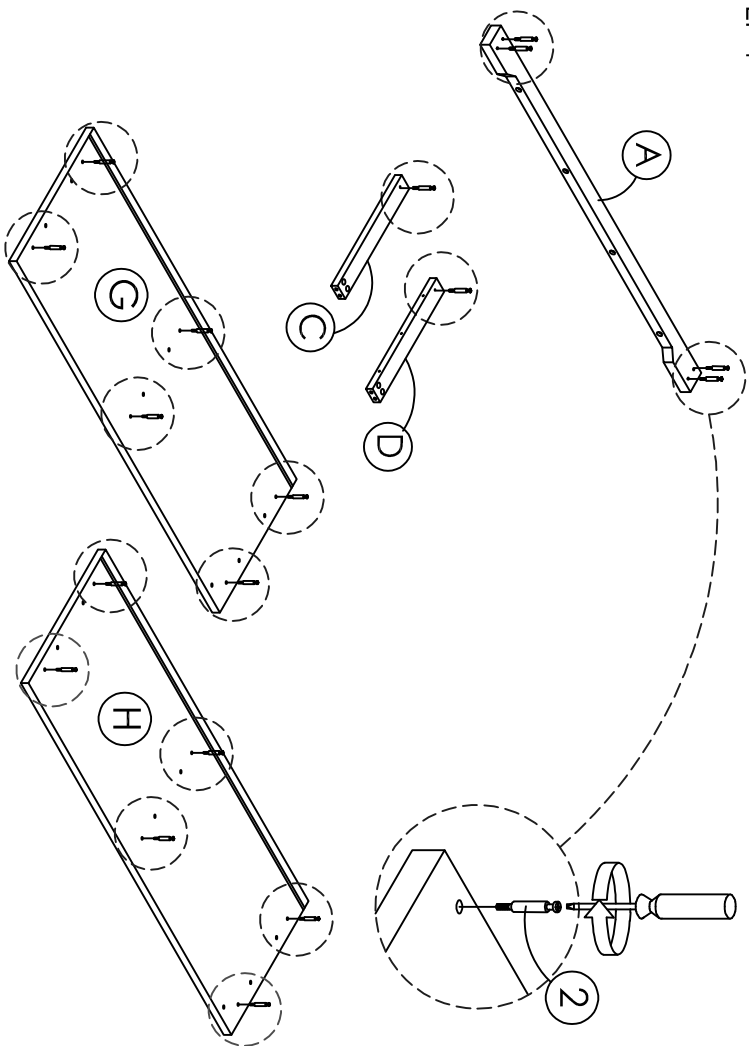

STEP 2

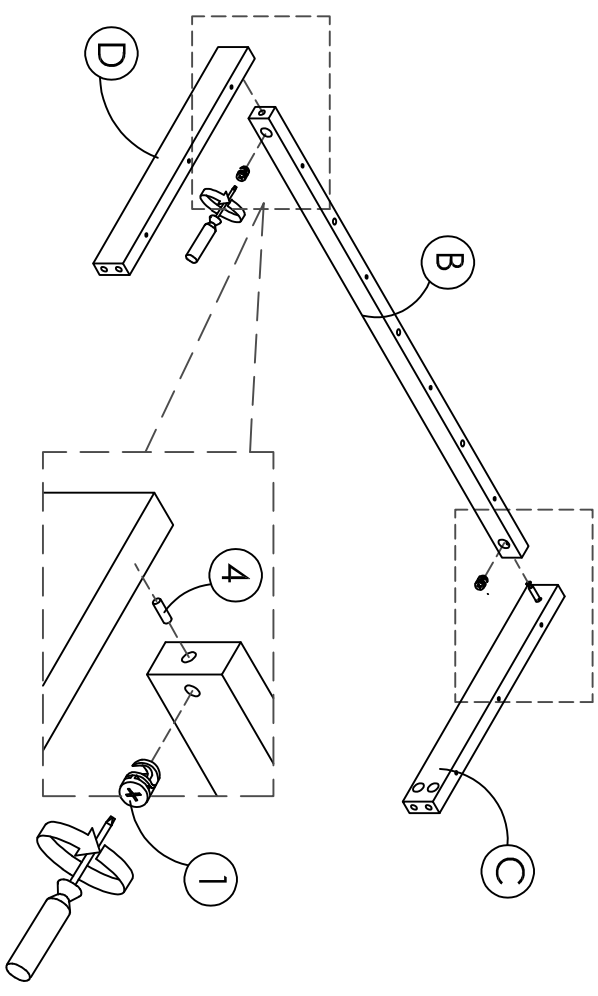

STEP 3

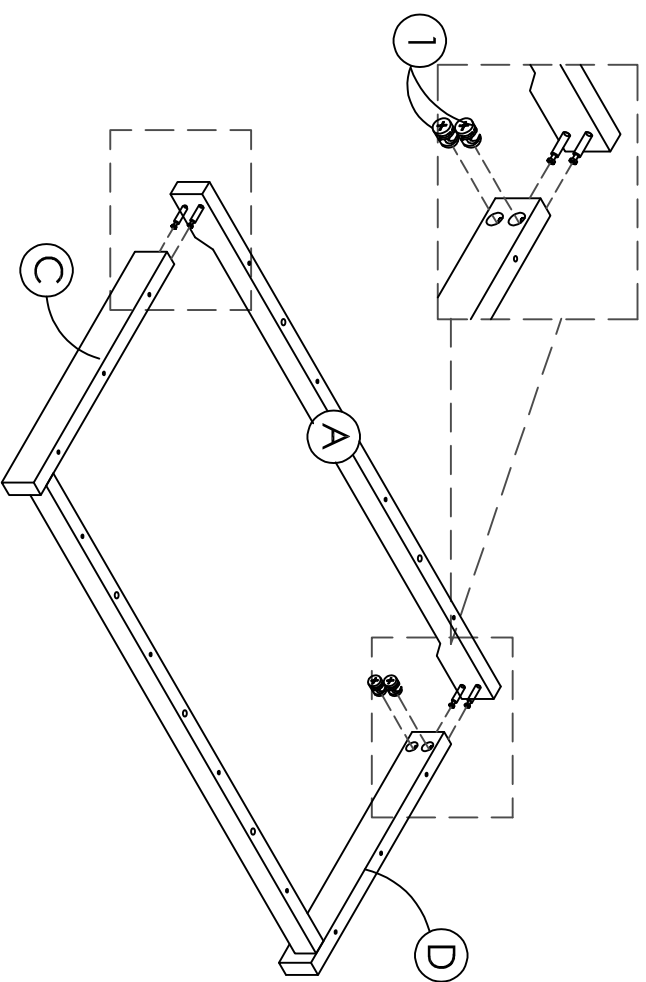

STEP 4

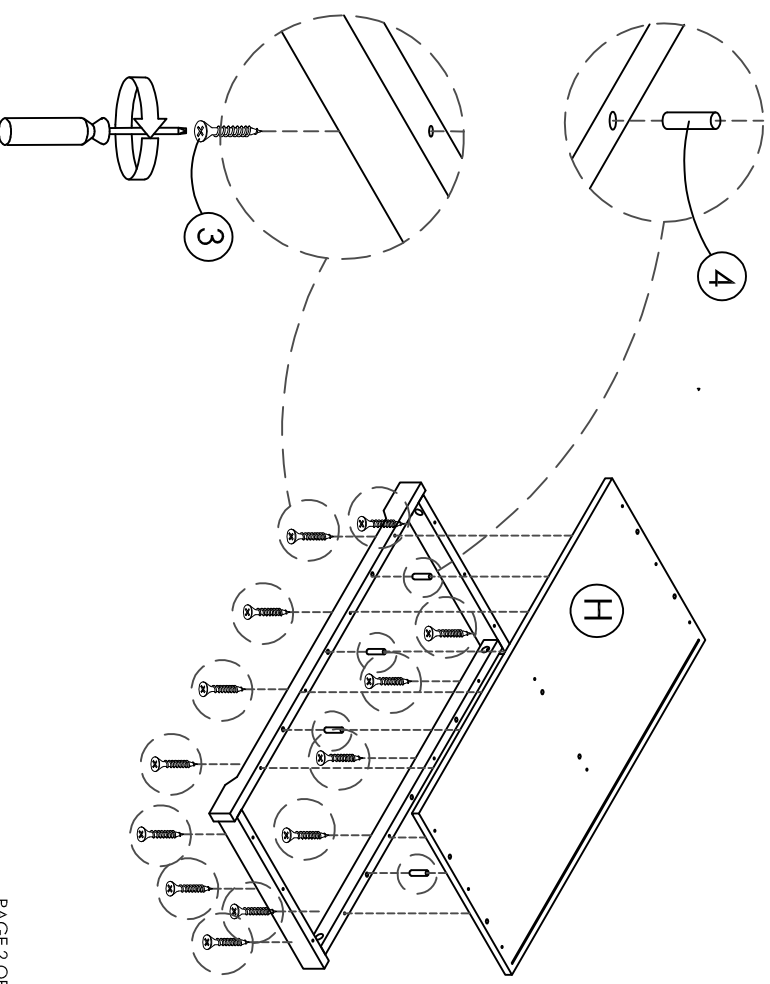

STEP 5

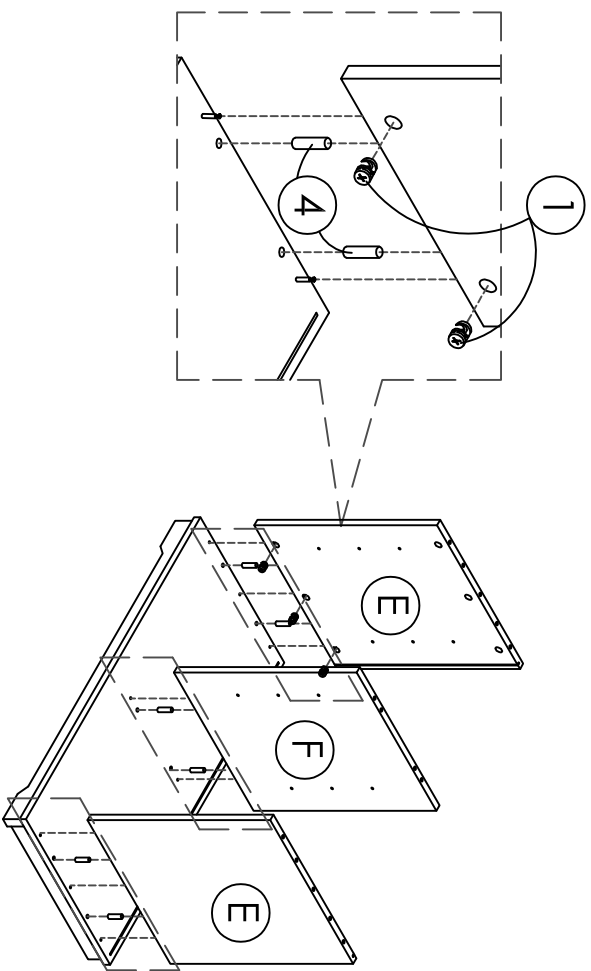

STEP 6

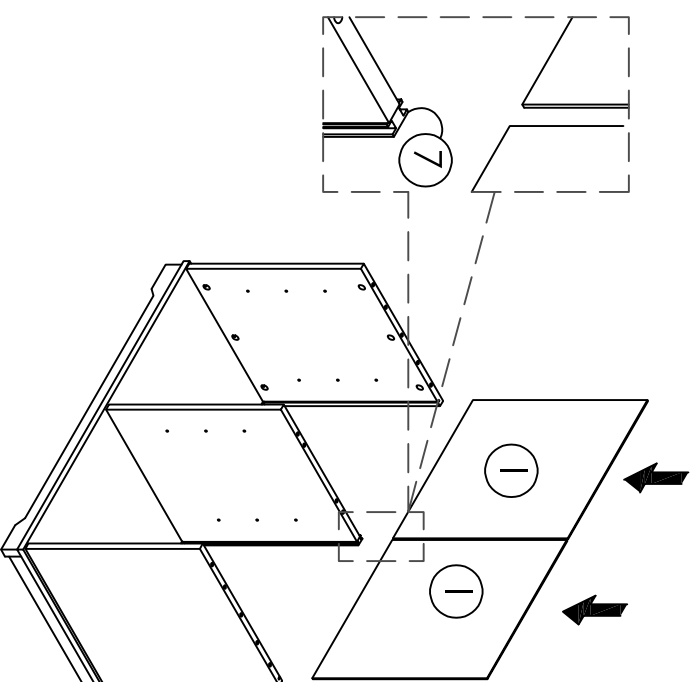

STEP 7

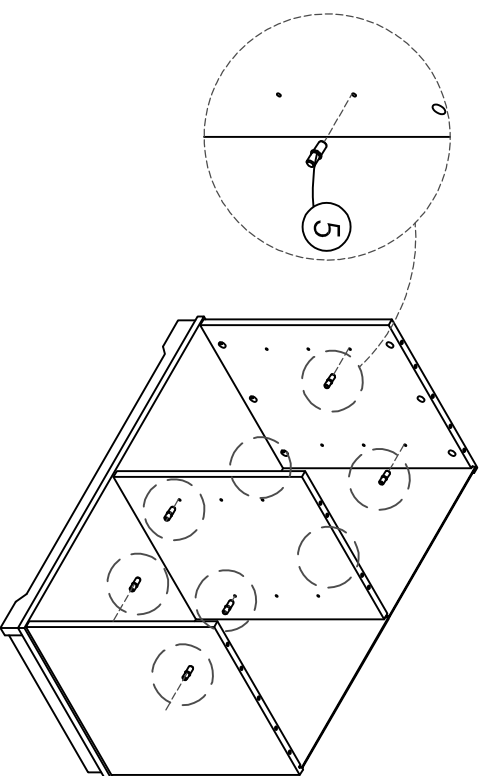

STEP 8

